

148 PROPERTY ASSESSMENT RECORD TOWN OF PORTAGE

CARD OF CARDS

MAP 16	LOT 24	ROAD	115 West Road				SINGLE FAMILY	RESIDENTIAL	SUMMARY	
		OWNER					TWO FAMILY	SEASONAL		
								APARTMENT	OTHER	13

RECORD OF OWNERSHIP	DATE	BK	PG	RET ST		13	TOTAL	64900
Burby, Gary	1/29/1998	3101	122		BP- House Add'd 2019-4	14	LAND	10400
						20	BLDGS.	56300
						20	TOTAL	66700
						20	LAND	10,400
						20	BLDGS.	61,000
						20	TOTAL	71,400
						20	LAND	
						20	BLDGS.	
						20	TOTAL	
						20	LAND	
						20	BLDGS.	
						20	TOTAL	

INTERIOR INSPECTED YES NO-EST DATE *2019-4*

REMARKS:
+ Gary S. Burby
 In Process of New Garage. Concr Slab
 Now.
 5-3-14 Remove Truc. on garage.

LAND VALUATION							LAND FACTORS		
CLASSIFICATION	ACRES	%	PRICE	TOTAL	- DEPR	+	VALUE	MINUS	PLUS
HOUSE LOT	<i>Imp'd</i>		<i>5000</i>				<i>5000</i>	VACANCY	COMM. INFL.
BASE	<i>0.46</i>	<i>67%</i>	<i>800</i>				<i>5360</i>	SEMI-IMP	OTHER
FRONT ACRES								TOPOGRAPHY	
ACREAGE								ACCESS	
TILLABLE								R/W	
PASTURE								SIZE	
WOODLAND								SHAPE	
WASTE								USE	
TOTAL	<i>0.46</i>						<i>10360</i>		

LOT COMPUTATIONS							OTHER FACTORS		
FRONTAGE	DEPTH	UNIT PRICE	DEPTH %	FR FT PRICE	TOTAL	DEPR	VALUE	LEVEL	PAVED ROAD
								ROUGH	GRAVEL ROAD
								ROLLING	TOWN WATER
								SWAMPY	DRILLED WELL
								HIGH	DUG WELL
								LOW	TOWN SEWER
LOCATION				AREA TRENDS					SEPTIC
G	F	P		IMPROVING	STATIC	DECLINED			



CONSTRUCTION

1 FOUNDATION	G	F	P	6 FLOORS	YEAR	COST
CONCRETE				B 1 2 3 G F P		
CONC BLOCK		✓		CONCRETE		
CONC SLAB		✓		EARTH		
BRICK OR STONE				PINE		
PIERS				HARDWOOD		
2 BASEMENT				INLAID		
FULL HR				W/W CARPET		
1/4 1/2 3/4				CERAMIC		
FIN BSMT AREA				SINGLE		
BSMT GAR						
FRAMING				ATTIC FLR & STAIRS		
FLR JOISTS				7 INTERIOR FINISH		
2x8 160/c				B 1 2 3 G F P		
BEAMS & COL				PLASTER		
STUDS				DRYWALL		
3 WALLS				PANEL		
DOUBLE SIDING				KNOTTY PINE		
SINGLE SIDING				WALLBOARD		
SHINGLES				UNFIN		
CONC BLOCK				FINISH ATTIC AREA		
FACE BRK ON				8 HEATING	M	O
SOLID COM BRK				HOT AIR		
INSULATION				HOT WATER/VAPOR		
ATTIC ONLY				STEAM		
ROOFING				AIR COND		
ASPH SHINGLES				PIPELESS FURN		
WOOD SHINGLES				FLOOR FURN		
METAL				AUTO OIL BURNER		
ROLL ROOFING				GAS		
ROOF TYPE				ELECTRIC		
GABLE				NO HEATING		
HIP				UNIT HTRS		
GAMBREL				9 PLUMBING	M	O
4 LIGHTING				BATHROOM		
NO ELEC				TOILET ROOM		
OUTLETS				WATER CLOSET		
WIRING				LAVATORY		
5 FIREPLACES				STALL SHOWER		
# OF STACKS				KITCHEN SINK		
FIREPLACE STACK				AUTO WATER HEATER		
FIREPLACE				NO PLUMBING		
HEARTH						
NO OF ROOMS						
BSMT	1ST	4+B				
2ND	3RD					
INT LAYOUT						

REMODELING DATA

STRUCTURAL	YEAR	COST
KITCHEN		
ELECTRICAL		
PLUMBING		
HEATING		
COMPUTATIONS		
UNIT	AMOUNT	
604 SF	48028	
BSMT AREA	-1212	
BSMT GAR		
WALLS		
INSULATION		
ROOFING		
LIGHTING		
FIREPLACES		
FLOORS		
ATTIC		
INT FINISH		
HEATING		
PLUMBING		
TOTAL	46226	
ADDITIONS & PCHS		
1 154 (CER) SF	+ 5410	
2 180 15F/CS SF	+ 7170	
3 SF		
4 SF		
5 SF		
6 SF		
7 SF		
8 SF		
9 SF		
TOTAL	58,806	
FACTOR	82	
FIN BSMT		
REPL VALUE	48,220	
OCCUPANCY	CONSTRUCTION	SIZE
Cap	15F/CS	22
OUT BLDGS.		
1 15F/CS	1302	286
2 15F	1232	384
3 Garage	15F/CS/146	3240
4		
5		
6		
7		
8		

SKETCH

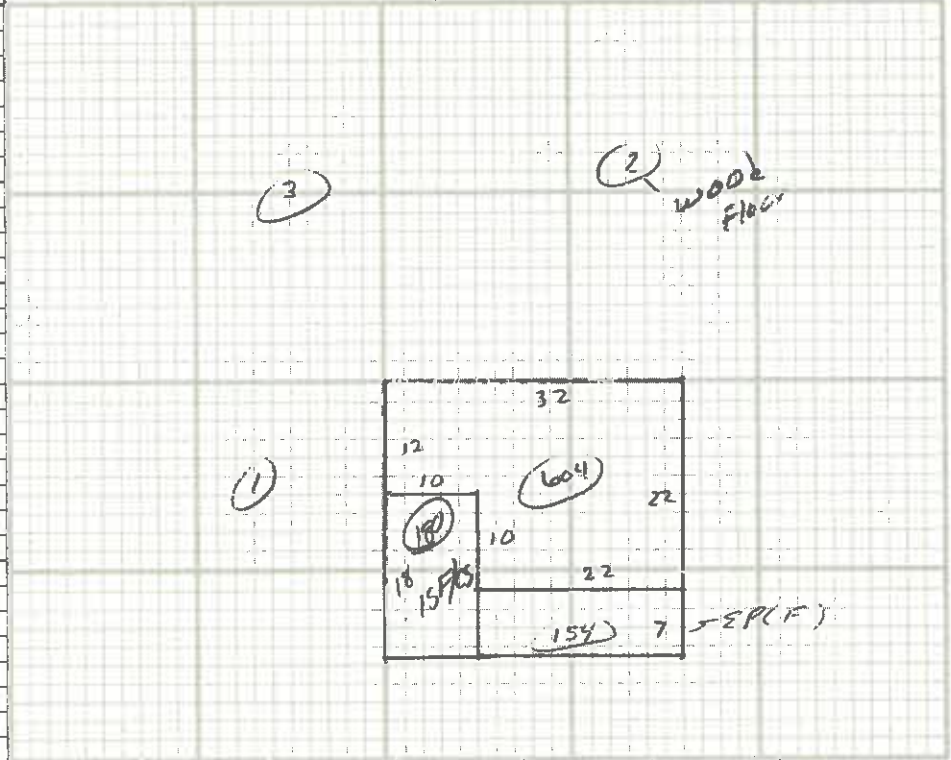

SPLIT LEVEL	RANCH	GARRISON	CAPE	MODULAR	CUSTOM	DATE LISTED
DATE	MO.	YR.	TYPE	SALE PRICE	SOURCE	DATE LISTED
			1. LAND 2. L & B 3. BLDG		1. BUYER 2. SELLER 3. DECL. 4. AGENT	LISTED
				31000	1 2 3 4	MEAS
					1 2 3 4	PRICED
						REV'D.
INTERIOR CONDITION COMPARED TO EXTERIOR						
Compare to 19-4-10-14						

SURPLUS CAPACITY	ENCROACHMENTS	PLUMB & HEAT	UNFINISHED									
			10									
STYLE <th>COMM. LOCATION</th> <th>ECONOMIC</th> <th></th>	COMM. LOCATION	ECONOMIC										
OCCUPANCY	CONSTRUCTION	SIZE	AREA	GRADE	AGE	REMOD	COND	REPL VAL	PHYS DEP	PHYS VAL	OBSOL.	SOUND VALUE
Cap	15F/CS	22	604	D	1951		G	48,220	20	38,576		38,576
1	15F/CS	1302	286	10'				2860	10	2574	25	1930
2	15F	1232	384	10'	2012			3840	5	3648	25	2730
3	Garage	15F/CS/146	3240	1280	CA19	2012		18124	2	17762		17762
4												
5												
6												
7												
8												
TOTAL VALUE BUILDINGS												61,004